

拓尔T12-11

数字智能无铅焊台

使用说明书

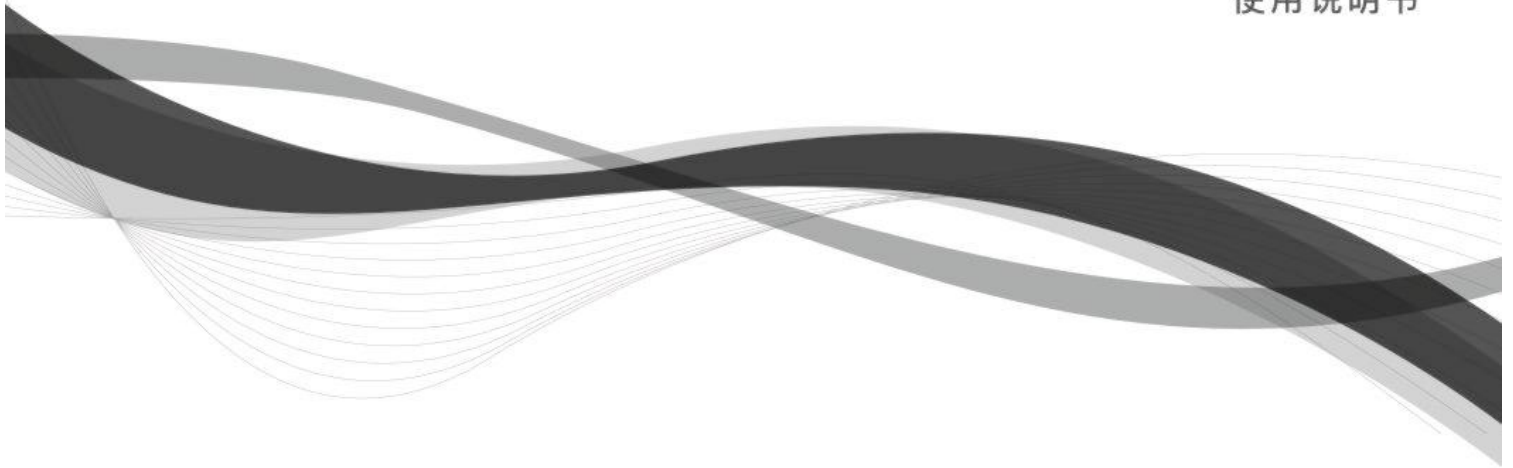

» 全球无铅焊接新标杆

The pacemaker in the world field of lead-free soldering

Digital Intelligent Lead-free Soldering Station

Contents

01 Parts description	1
02 Installment	3
03 Operating instructions	4
04 Attentions for cartridge using and changing	6
05 Troubleshooting & error indication	7
06 Temperature calibration	8
07 Specifications	9
08 Soldering suggestion	9
09 Safety precautions & attentions	10
10 Technology and structure of cartridge	11
11 Type list of T12-11 tips	12

01 Parts description

Thank you for choosing our product!

This machine has passed strict quality tests, and it will provide you the best service.

Please read this manual carefully before use, and follow the instructions to use and operate.

1. Digital Intelligent Lead-free Soldering Station



01 Parts description

2. MAIN CONTROL STATION

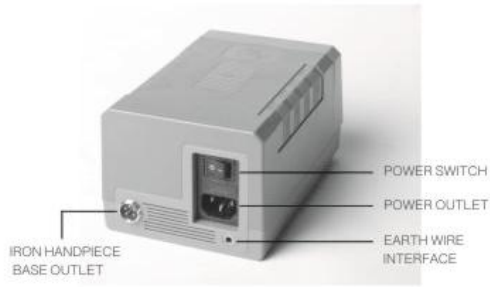

3. IRON HANDPIECE BASE



02 Installment

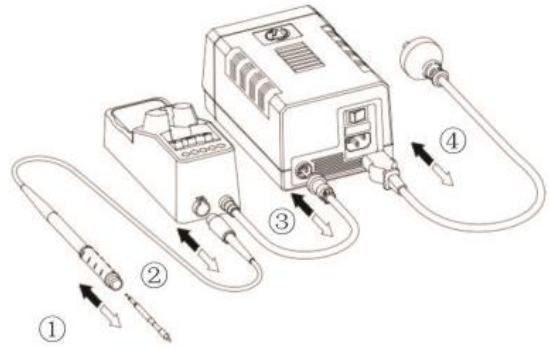

- ① Plug cartridge into iron handpiece
- ② Connect iron handpiece to iron handpiece base
- ③ Connect iron handpiece base to main control station
- ④ Confirm the power connection of main control station
- ⑤ Start up the machine and adjust the operating temperature

03 Operating instructions



The LED display can reflect different working states, as follows:

温控无铅焊台

设备状态: 工作中
当前温度: 349°C
设定温度: 350°C

Working mode:

The equipment is normally running and LED display should be always on, and it is in the working mode.

03 Operating instructions

温控无铅焊台

设备状态: 休眠中
当前温度: 150°C
设定温度: 350°C

Sleep mode:

When the iron handpiece is placed on iron handpiece stand, the device will automatically turn into sleep mode after 3 seconds, and the cartridge temperature will decrease slowly to the setting temperature on sleep mode (150°C). After 30 minutes in sleep mode, the cartridge drops to room temperature from 150°C, and LED display turns to black.

温控无铅焊台

设备状态: 停机中
当前温度: 136°C
设定温度: 350°C

Stop mode:

When the iron handpiece is placed on cartridge changing slot for changing, the device will suspend working. It will return to working mode after 5 seconds while taking up the cartridge.

So, we advice you to change the cartridge in 5 seconds.

When the iron handpiece is placed on its stand, the device will automatically turn into sleep mode temperature (150°C). Users can see the setting temperature dropping through LED display. Sleep mode can greatly reduce the oxidation of the cartridge because the lifetime of the cartridge depends greatly on its temperature and operating time. So it is wise to put the iron handpiece on the its stands when not in use.

04 Attentions for cartridge using and changing

1. Changing cartridge

Based on advanced system, you can change the cartridge swiftly without turning off the power. The quick way for cartridge changing is shown as follows:



a. Use the cartridge changing slot (slot above) to release the cartridge



b. Align the iron handpiece to a new cartridge, slightly press the iron handpiece down to join them together and pick up the iron handpiece.



c. Push it hard into the cartridge changing slot (slot in the middle) to fasten the iron handpiece and cartridge together.

Note: 5 seconds after iron handpiece removing from cartridge changing slot, the LED display should light up and the buzzer starts to alarm, and the machine gets back to working mode.

Attentions for cartridge using

Except for copper core, other materials are thin layers, so you must be careful to protect them. When cleaning the cartridge, please use the sponge in the cleaning pot on the iron handpiece base. Please only use deionized water to wet the sponge. If you use common water, the cartridge may be "polluted" by the salt which dissolved in water.

05 Safety precautions & attentions

- If LED display is still black after starting up, maybe the fuse has been blew out. You need to install or change the fuse.

1. Unplug the power cord and power off
2. Pull out the fuse holder
3. Replace the fuse with a new one
4. Put it back as it is



- If the device is not working properly after starting up, and "STATE" place on LED display appears following information, here is the solution

No cartridge:

The device can not find the cartridge

Reasons:

1. No cartridge inserted
2. The cartridge is not inserted in place.
3. The cartridge has been damaged.

温控无铅焊台

设备状态: 无焊笔
当前温度: 025℃
设定温度: 350℃

Solution: Pull off and insert the cartridge again or try other cartridges, if still not work please restart the machine.

05 Safety precautions & attentions

Overcurrent:

Transient current is too large detected by equipment

Reasons:

1. Bad cartridge (short circuited)
2. A bad contact occurs when the cartridge inserted into the iron handpiece

Solution: Restart the machine twice, if still overcurrent, maybe the cartridge has been damaged and you need to change a new cartridge.

No inner core:

The equipment can not measure the temperature

Reasons:

1. This is due to bad contact

Solution: Pull off and insert the cartridge again, let the cartridge touch the cartridge changing slot and remove it after you hear the sound "click". In this way, the equipment can change to working mode from stop mode. Or restart the machine.

温控无铅焊台

设备状态: 过电流
当前温度: 031℃
设定温度: 350℃

温控无铅焊台

设备状态: 无内芯
当前温度: 031℃
设定温度: 350℃

06 Temperature calibration

This function provides accurate calibration between setting temperature and actual temperature. If you find deviations between setting temperature and actual temperature during use, please try the following

1. Power off
2. Press "Set" and hold on, then power on
3. Adjust "inner core" value
4. Press "OK" to confirm
5. Power off and power on

07 Specifications

Technical specifications			
Temperature selection from 100°C to 500°C			
Power	75W		
T12-11230V	main control unit	input: 230V 50Hz	output: 24V
Total weight 2	265kg	2	
ESD protection stand			
leakage resistance	< 0.2Ω		
The product is made according to CE standard, and it has ESD protection and VERIFICATION OF EMC COMPLIANCE.			
The main control unit should be connected to ground wire for anti-static protection.			

NOTE: the machine include includes outer package, main control unit, cartridge, iron handpiece base, iron handpiece, user's manual, power wire, ESD protection stand, and cleaning pot.

08 Soldering suggestion

1. Clean the working table and circuit boards, and make sure there is no dust and dirt.
2. You'd better set temperature below 350°C, because high temperature may burn out circuit board.
3. For greater heating conductivity, please totally cover the tips with soldering tin.
4. Even the product has not been used for a short time, the tip must keep covering with the soldering tin to reduce oxidation and extend its life.

09 Safety precautions & attentions

For your own safety, please strictly observe the following

「WARNING」

- Don't touch materials around tips.
- If it is not used correctly, it could cause a fire
- Keep away from the flammable gas
- Please tell the people around: "heat danger"
- Turn off the power when leaving or finishing using
- Please cool down the cartridge by putting it on its stand before storing

「attentions」

- Do not use it for other purposes except soldering
- Do not impose a strong impact on the cartridge
- Please hold the plug part to pull out the wire
- Refitting the product is forbidden.
- Please only use original accessory when changing any parts.

10 Technology and structure of cartridge

The cartridge has an independent heating system which includes a heater, a temperature sensor, and a long-life tip. Following is the structure of our cartridge:

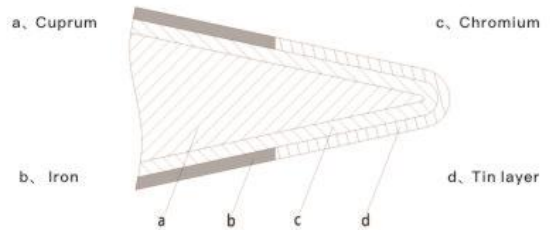

11 Type list of T12-11 tips

Type	model	details description	size of tip part	model
round	T12-I0.1		Φ0.1mm	T12-11
	T12-I0.3		Φ0.3mm	T12-11
	T12-I0.5		Φ0.5mm	T12-11
	T12-I0.8		Φ0.8mm	T12-11
	T12-I1.0		Φ1.0mm	T12-11
	T12-I1.2		Φ1.2mm	T12-11
	T12-I1.7		Φ1.7mm	T12-11
	T12-I2.2		Φ2.2mm	T12-11
	knife	T12-K2.0		2.0x2.8mm
T12-K3.5			3.5x5.0mm	T12-11
T12-K5.5			5.5x6.5mm	T12-11

11 Type list of T12-11 tips

Type	model	details description	size of tip part	model	
chisel	T12-D1.2		1.2x0.7mm	T12-11	
	T12-D1.8		1.8x0.8mm	T12-11	
	T12-D2.2		2.2x1.0mm	T12-11	
	T12-D3.2		3.2x1.2mm	T12-11	
	T12-D3.2T		3.2x1.5mm	T12-11	
	T12-D5.5		5.5x1.5mm	T12-11	
	round sloped	T12-C1.5		Φ1.5x45°	T12-11
		T12-C2.2		Φ2.2x45°	T12-11
		T12-C3.0		Φ3.0x45°	T12-11
		T12-C3.8		Φ3.8x45°	T12-11
T12-C5.0			Φ5.0x45°	T12-11	
Curved tip	T12-H0.1		0.1x12mm	T12-11	
	T12-H0.3		0.3x10mm	T12-11	

More into please check www.unionrepair.com

Mail: sales@unionrepair.com

Facebook: <https://www.facebook.com/unionrepaircom/>

Ins: <https://www.instagram.com/unionrepair/>